

# Likorall

242/243/250

## Quick Reference Guide

English

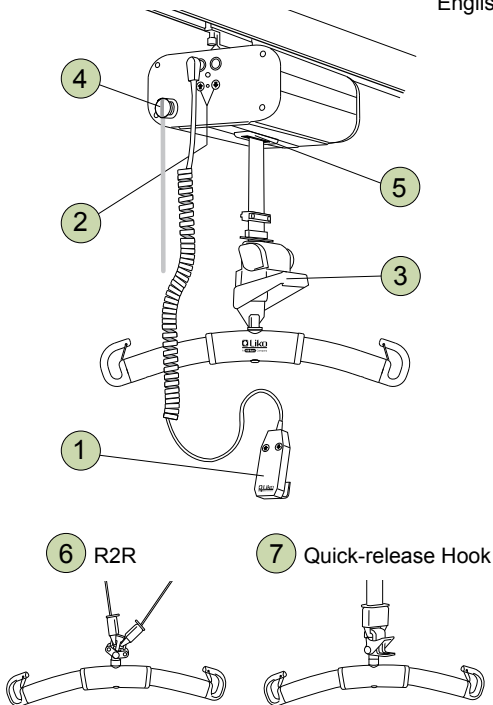

### 1 Hand Control

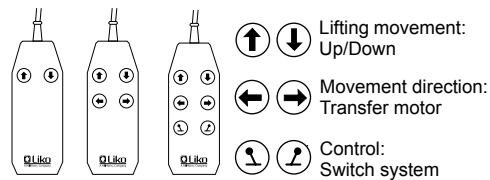

HandControl IR:

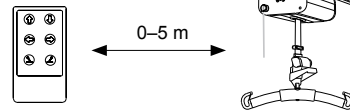

### 2 Emergency Lowering/Raising (Electrical)

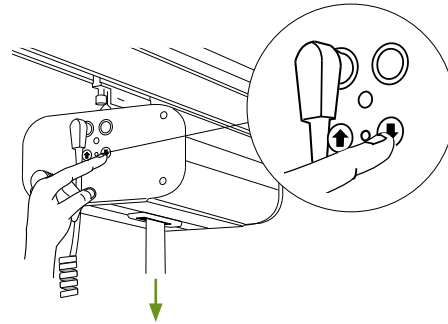

### 3 Mechanical Emergency Lowering

Exclusively: 242 S, ES

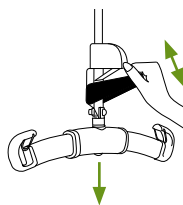

**Activate:**

Press down repeatedly on the emergency lowering handle.



**Reset:**

Remove load from the lift strap. Hold the emergency lowering handle down at the half-way position while at the same time turning the black knob clockwise.

### 4 Emergency Stop

**Activate:**

Alt. 1

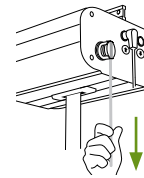

Alt. 2

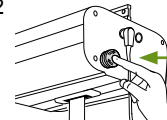

**Reset:**

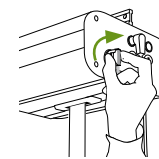

### 5 SSP Limit Switch

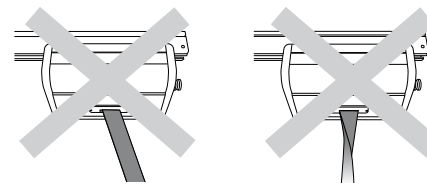

The lifting motion is interrupted when load on the lift strap is biased or when the lift strap is twisted.

### 6 7 Sling Bar Connection

**6. The R2R sling bar** has hooks for two lift straps to enable transfer between two lifts.

**7. A sling bar with a Quick-release Hook** enables fast and easy exchange of sling bars.

### Charging of Batteries

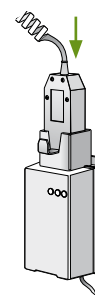

- Charge the lift regularly after use.
- The lift does not function during charging.
- **Ensure that the emergency stop is not pressed in during charging.**

### Safety Instructions

- Read the instruction guides for the lift and lifting accessories before use.
- Before the patient is lifted from the underlying surface, but after the straps have been fully extended, make sure the straps are properly connected to the sling bar.
- **Max. load Likorall 242: 200 kg (440 lbs).**  
**Max. load Likorall 243: 230 kg (507 lbs).**  
**Max. load Likorall 250: 250 kg (550 lbs).**

To retain max. load it is essential to use accessories rated for the same max. load or greater.

### IMPORTANT!

This quick reference guide does not replace the lift's instruction guide, which can be downloaded from [www.liko.com](http://www.liko.com).

### Ergonomics

- Never lift manually – let the lift do the lifting.
- Take it easy. Work calmly and methodically.
- Don't strain your back! Work in a walking stance with your back straight.
- Use the bed's raising and lowering functions.
- Reduce the lever effect. Work close to the patient and the lift.

### Cleaning

When necessary, clean the lift with a moist cloth, using common surface cleaners or disinfectants.

### Simple Troubleshooting

**Check to ensure that:**

- emergency stop is not pressed in
- the battery is charged
- the hand control is properly connected
- the mechanical emergency lowering device has been reset.

### Other Quick Reference Guides

Quick reference guides for Liko's lifts and slings are available for downloading from [www.liko.com](http://www.liko.com).

© Copyright Liko AB



A Hill-Rom Company

[www.liko.com](http://www.liko.com)

Manufacturer:

Liko AB  
SE-975 92 Luleå  
Sweden  
[info@liko.se](mailto:info@liko.se)